

Baltimore City Public Schools
21st Century School Buildings Program
Maryland Stadium Authority



**PATTERSON HIGH SCHOOL
&
CLAREMONT MIDDLE/HIGH SCHOOL**
Grades 6 through 12

UDARP Work Session
06 April 2017



Project Team

Owner

Maryland Stadium Authority

User

Baltimore City Public Schools
21st Century School Buildings Program

Architect

Stantec
JRS Architects (associate architect)

Landscape Architect

Mahan Rykiel Associates

Civil Engineer

Carroll Engineering

Construction Manager

Skanska

Project Description

Patterson Overview



- Serves Grades 9 – 12
- Diverse, Multi-Lingual Population
- ELL, SPED Programs
- Academy Model School
- Active Community / Alumni Network

Claremont Overview



- Serves Grades 6 – 12, Ages 12 – 21
- Moderate to Severe Disabilities
- Life Skills, OT/PT, Special Olympics
- Outdoor Learning / Play / Adaptive P.E.
- Separate Public Day School

Building Overview

Total Building Area:	240,000 sf
• Patterson	194,800 sf
• Claremont	45,200 sf

Design Capacity:	1,512 pupils
• Patterson	1,372 pupils
• Claremont	140 pupils

21st Century Design Features

- Collaborative Learning
- Flexible, Adaptable, Sustainable Spaces
- Community-Oriented
- Outdoor Learning Spaces

Concept Floor Plans (Previously Presented to UDARP)

1st Floor



Concept Floor Plans (Previously Presented to UDARP)

2nd Floor

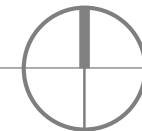
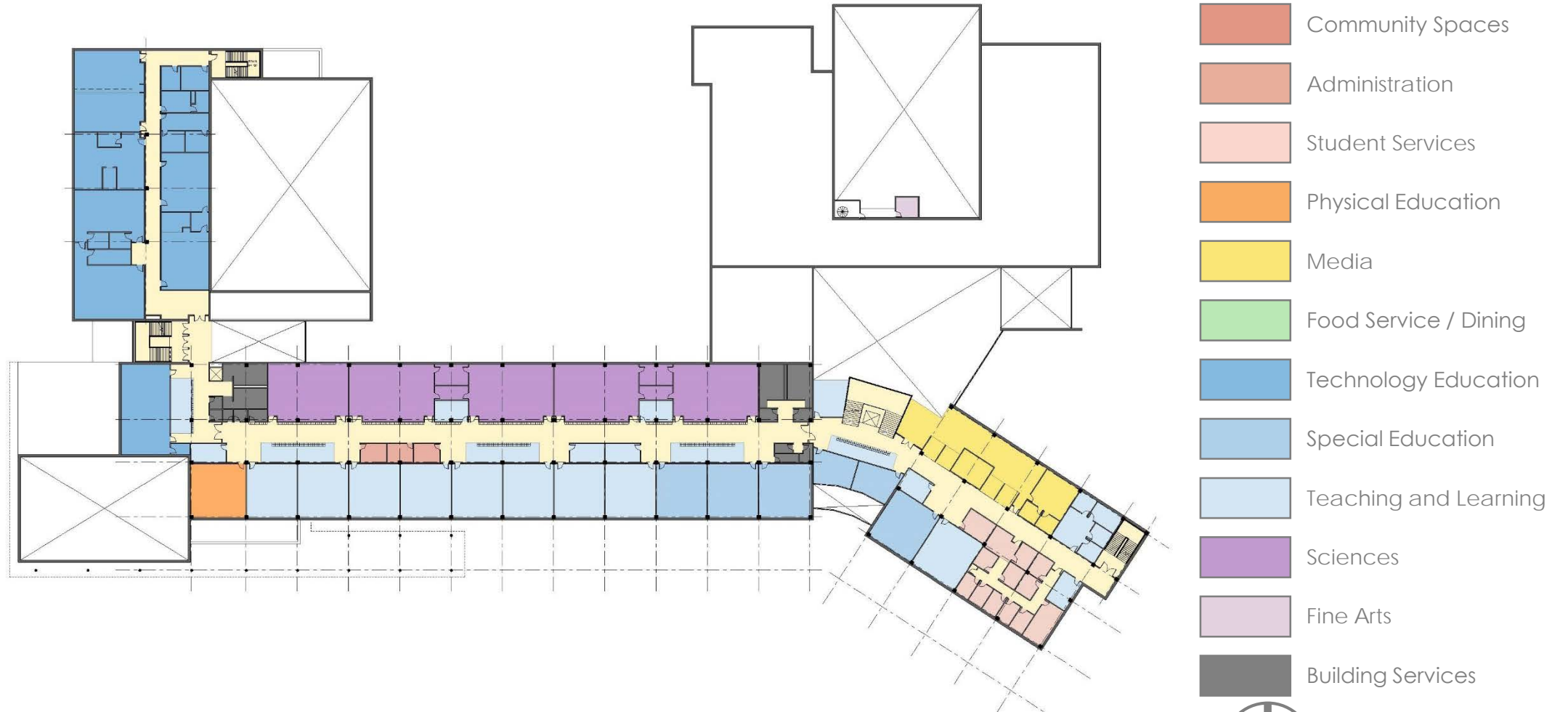

Concept Floor Plans (Previously Presented to UDARP)

3rd Floor

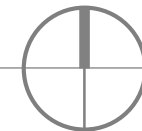
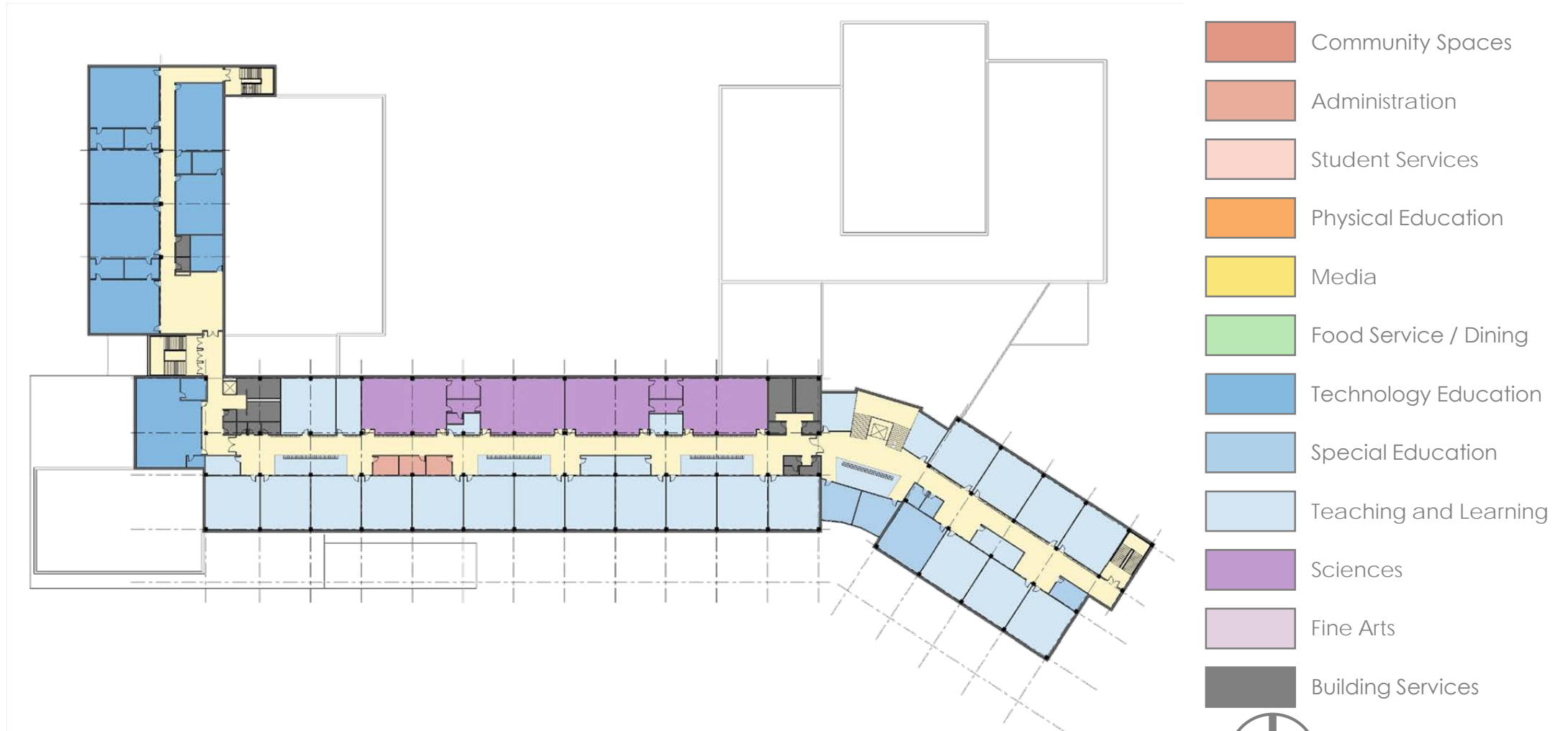

UDARP Comments on Building Design

1. Consider Grouping Community Accessed Facilities into 1 Location/Entry Point

- Community currently has 2 entries (cafeteria/auditorium and PE Facility)

2. Consider Grouping all Ground Level Accessed Facilities for Patterson to 1 Location

- Auditorium/Cafeteria/Administration vs PE Facility seems problematic

3. Reconsider Location and Visual Prominence of Claremont Entrance

- Feels lost behind a sea of parking
- Visually remote from Kane Street

4. Reduce Negative Impact of Long Double Loaded Corridors

- Create Activity Nodes along the corridor
- View the space as both directional as a route and static as a place

UDARP Building Comment

#1

Consider Grouping Community Accessed Facilities into 1 Location/Entry Point

- Community currently has 2 entries (cafeteria/auditorium and PE Facility)

Concept Plan

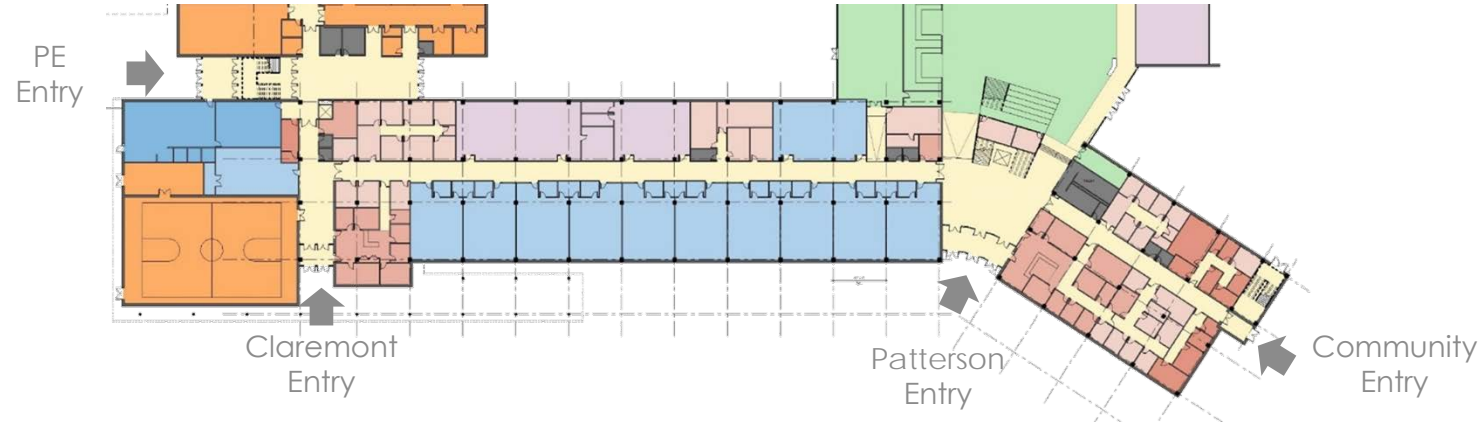

Current Plan

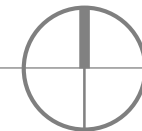

UDARP Building Comment

#2

Consider Grouping all Ground Level Accessed Facilities for Patterson to 1 Location

- Auditorium/Cafeteria/Administration vs PE Facility seems problematic

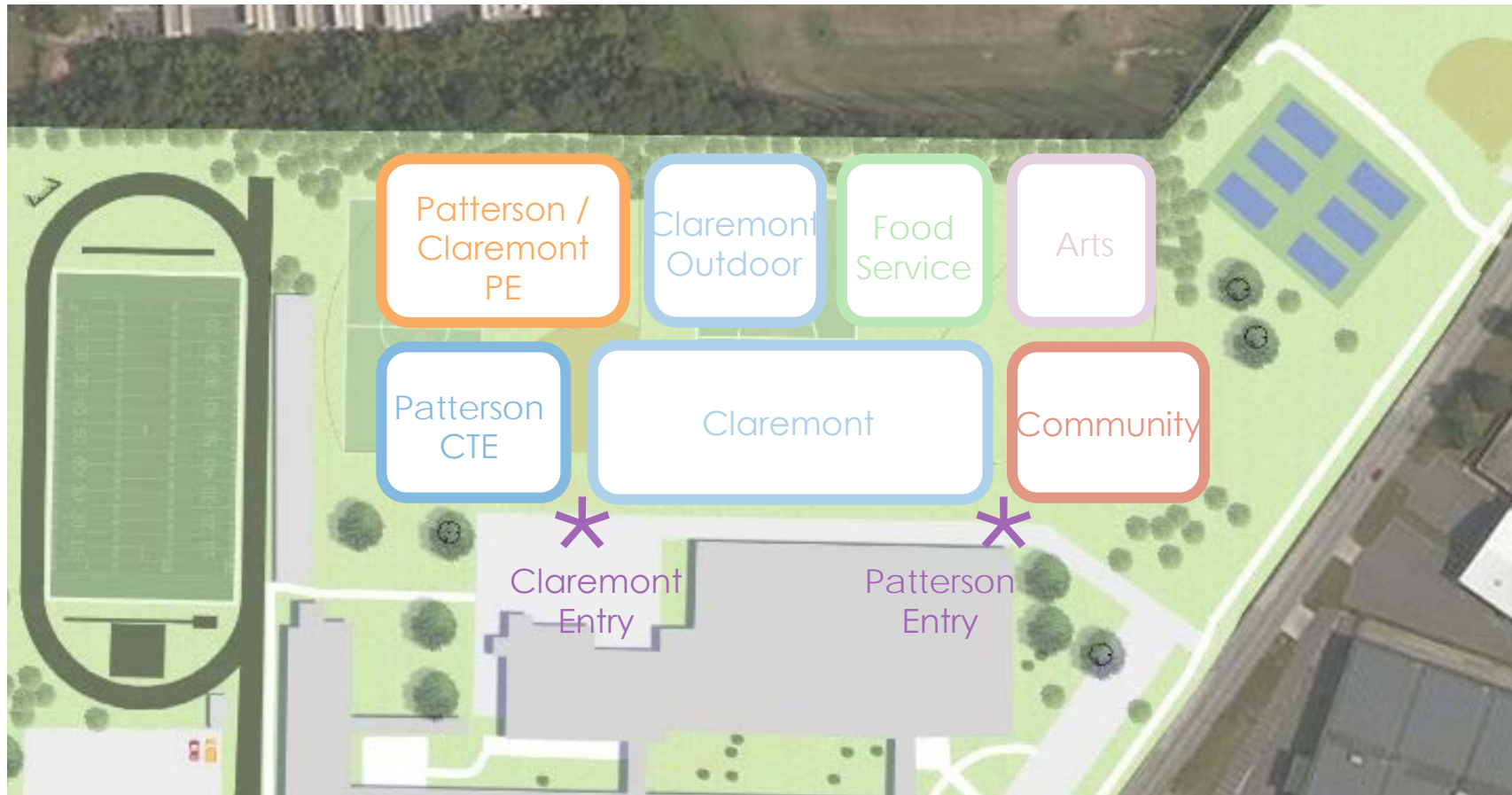

Programmatic Design Requirements

- Claremont program must be on ground level
- Claremont program must be contiguous
- Claremont Outdoor must be directly accessible from Claremont
- Claremont and Patterson must share a kitchen but not dining
- Patterson community may not pass through Claremont space during the school day
- Claremont and Patterson must have separate entrances
- Community members must pass through Patterson Entry security



UDARP Building Comment

#3

Reconsider Location and Visual Prominence of Claremont Entrance

- Feels lost behind a sea of parking
- Visually remote from Kane Street

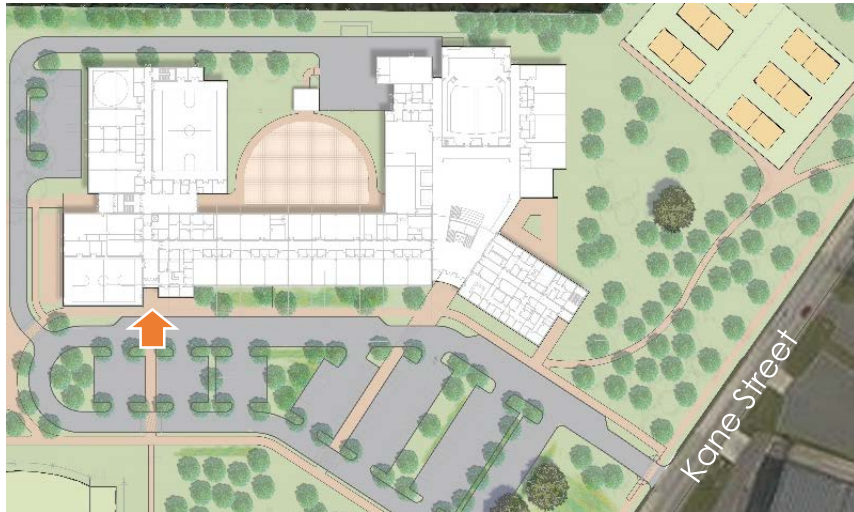

Concept Plan

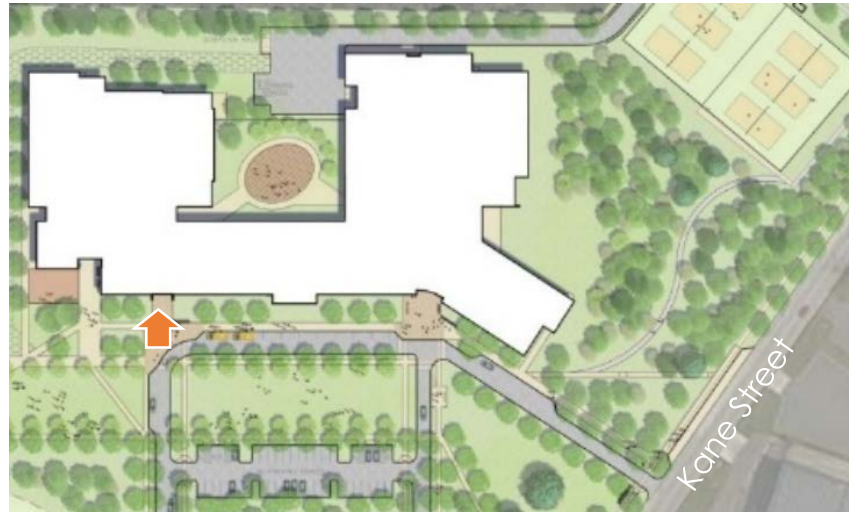

Revised Plan

Programmatic Design Requirements

- Claremont students require extensive assistance loading and unloading from busses
- Busses must have a place to stack while waiting to load/unload
- Busses may not stack in front of Patterson Entrance



UDARP Building Comment

#4

Reduce Negative Impact of Long Double Loaded Corridors

- Create Activity Nodes along the corridor
- View the space as both directional as a route and static as a place

Concept Plan



Revised Plan

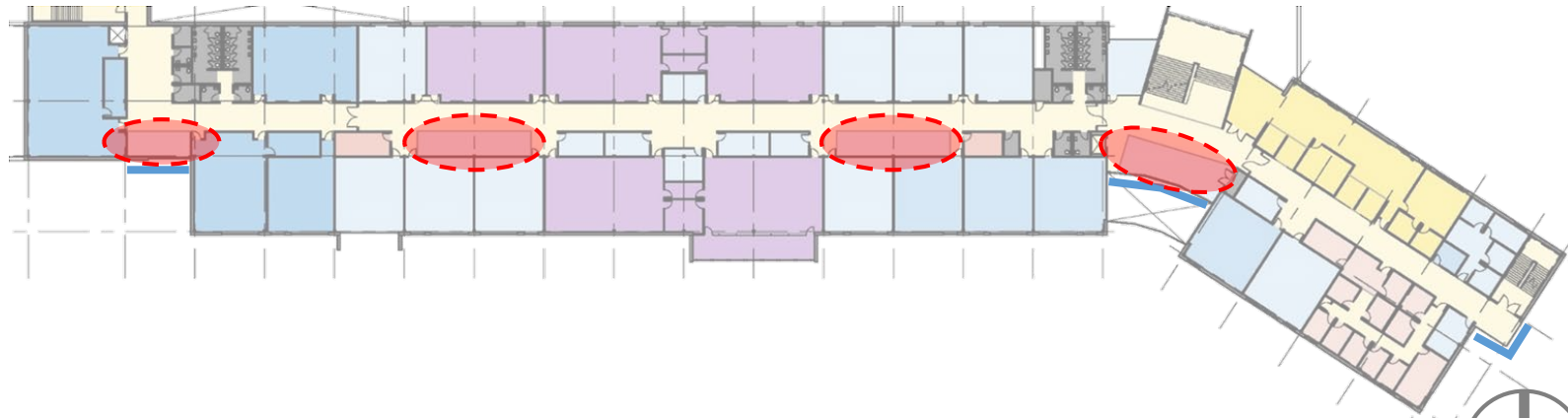

Revised Floor Plans

1st Floor



Revised Floor Plans

2nd Floor

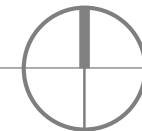
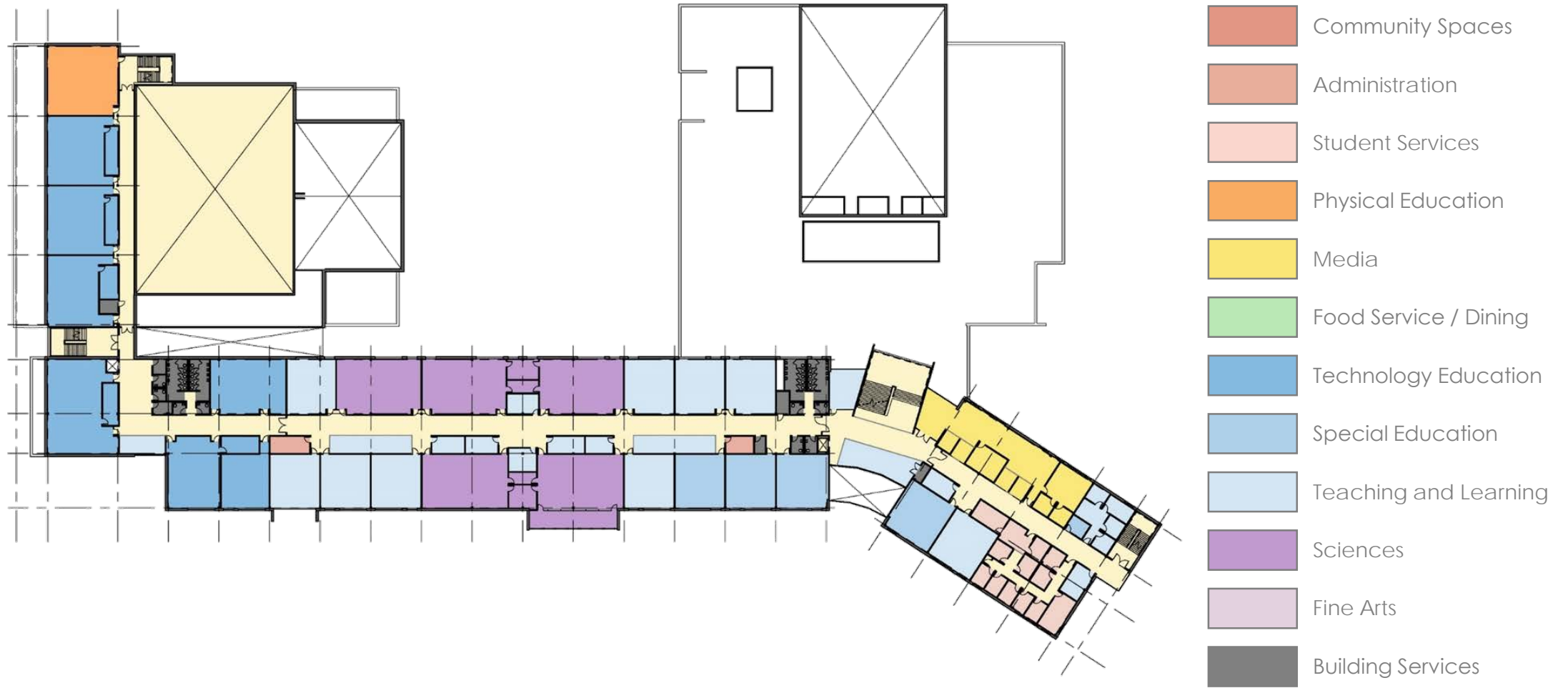

Revised Floor Plans

3rd Floor

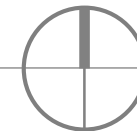
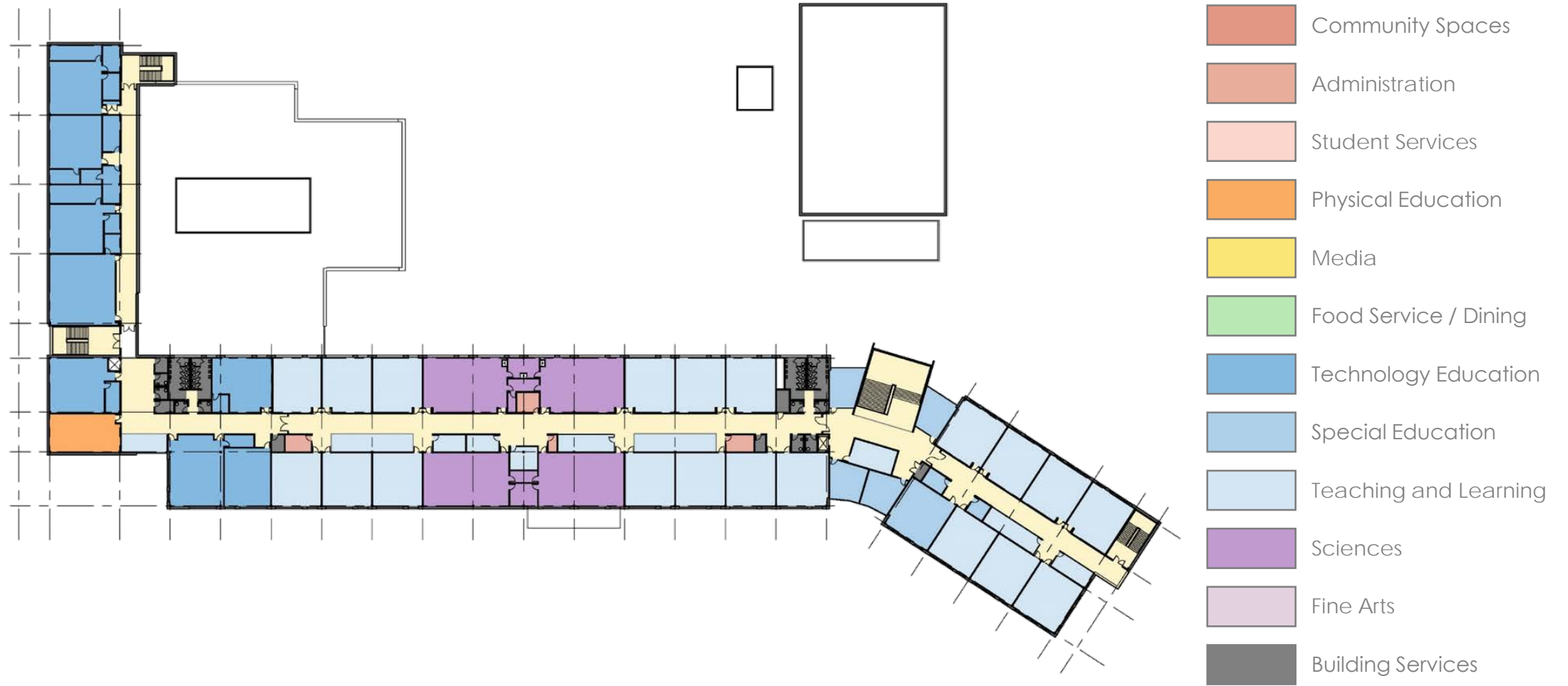

Site Context



Concept Site Plan (Previously Presented to UDARP)



UDARP Comments on the Site Design

1. Make a Strong Urban Gesture

- Site now disconnected from neighborhood context
- Reorient building to Kane Street to embrace the community and the urban context

2. Create a Meaningful Sense of Place

- Do not have dominant parking lot as “building forecourt”
- Create strong lawn at front of building to create sense of arrival

3. Improve Open Space Connectivity

- Strengthen connection of students in building to site open space and play fields
- Reduce parking and service access interference with this connection

4. Improve On-Site Vehicular Circulation

- Clarify parking zones, student drop-off zones, and separate points of entry
- Minimize vehicular/pedestrian conflict

Revised Site Plan



Make a Strong Urban Gesture

- Site now disconnected from neighborhood context
- Reorient building to Kane Street to embrace the community and the urban context

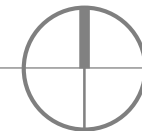



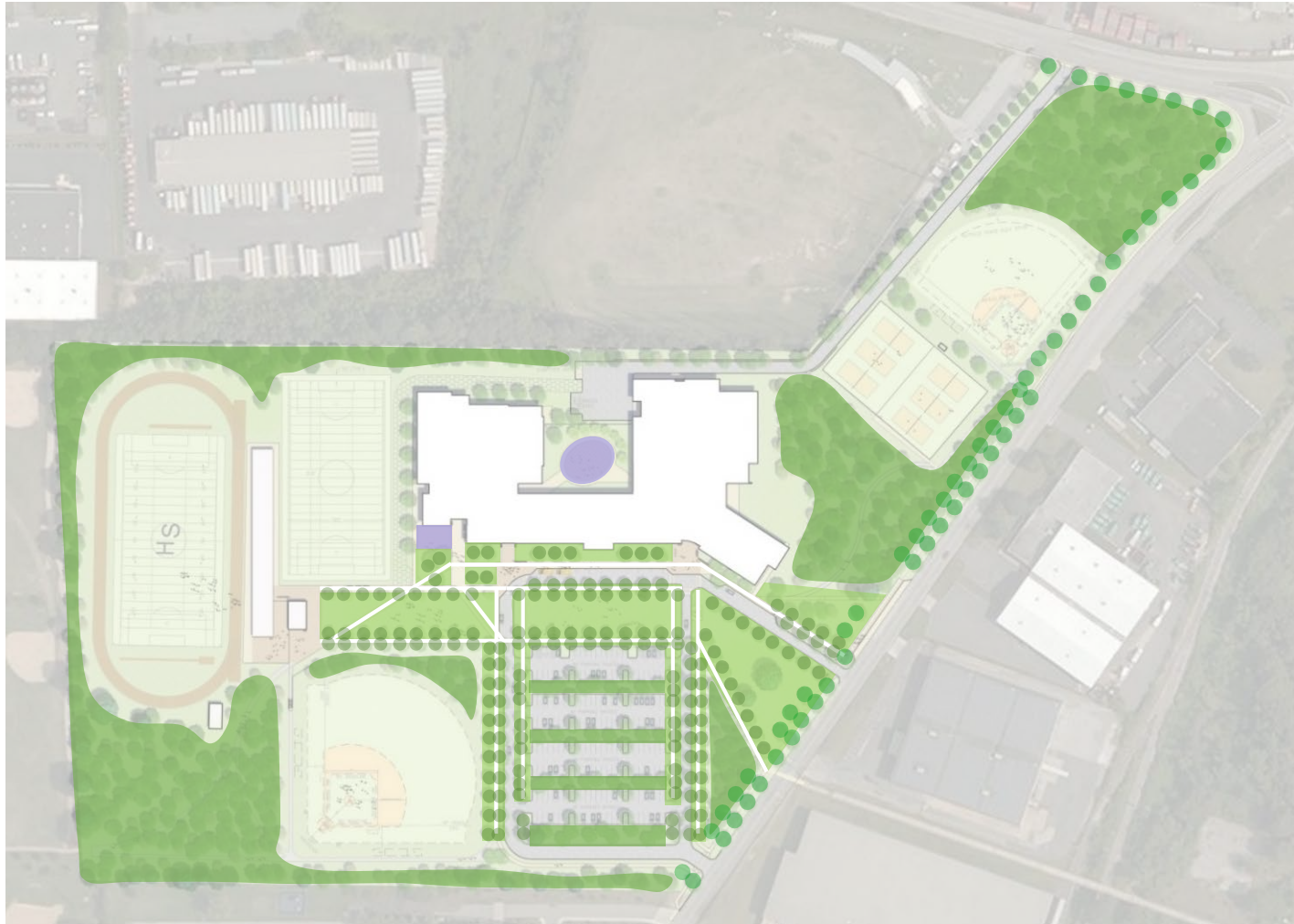

Site Open Space Character



Create a Meaningful Sense of Place

- Do not have dominant parking lot as “building forecourt”
- Create strong lawn at front of building to create sense of arrival

-  Natural Landscape Areas
-  Landscape ‘Mall’ / Building Approach
-  Allee and Pathway
-  Street Trees
-  Playground

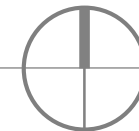

Site Pedestrian Circulation



Improve Open Space Connectivity

- Strengthen connection of students in building to site open space and play fields
- Reduce parking and service access interference with this connection

● Pedestrian Hub

— Pedestrian Circulation

➔ Building Entrance



Site Vehicular Circulation

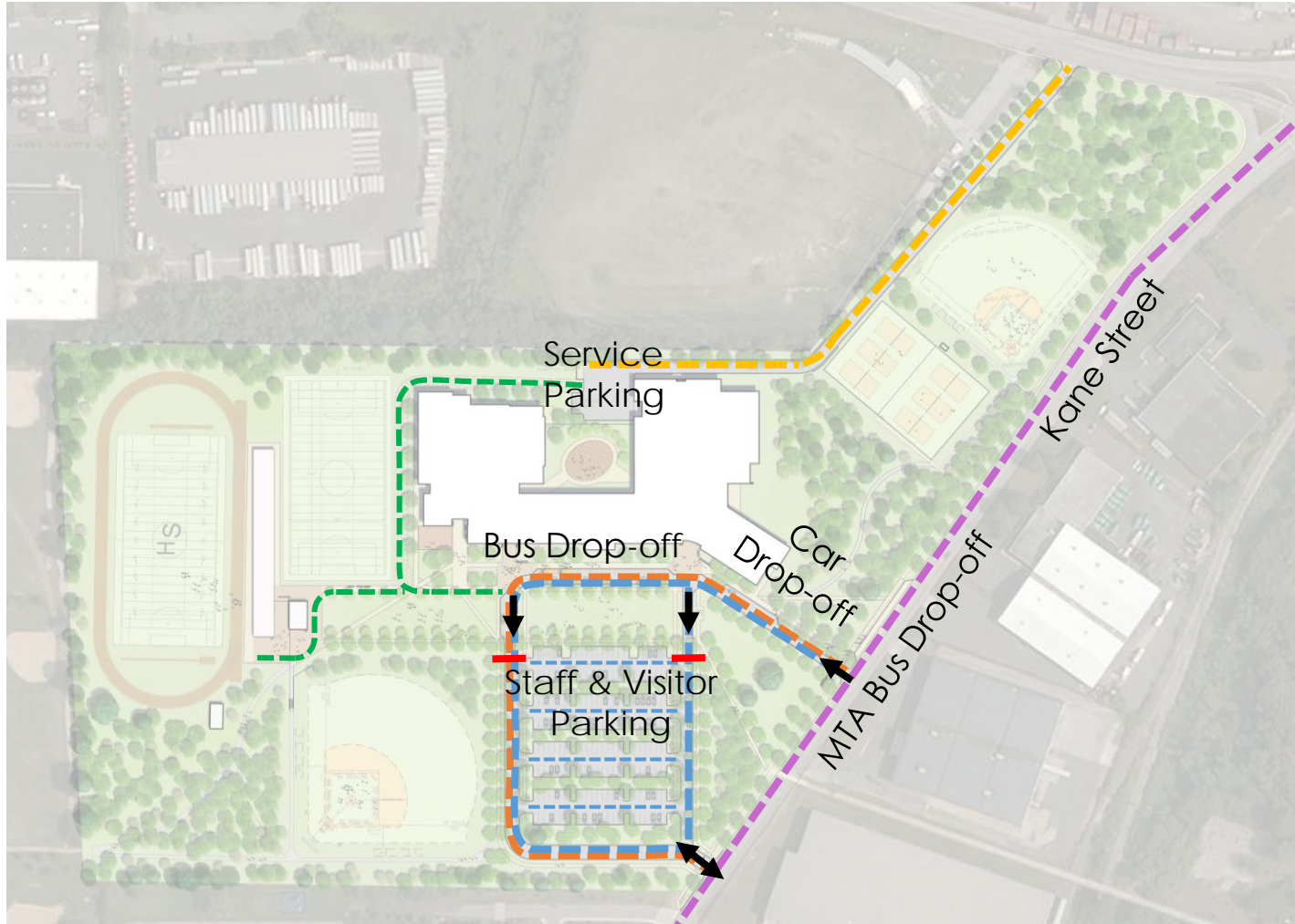

Improve On-Site Vehicular Circulation

- Clarify parking zones, student drop-off zones, and separate points of entry
- Minimize vehicular/pedestrian conflict

- School Buses
- Visitors & Staff Cars
- Service Vehicles
- MTA Buses
- Emergency Vehicles
- 2-Way Traffic Termination

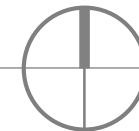

UDARP Site Comment

#4

Site Vehicular Circulation

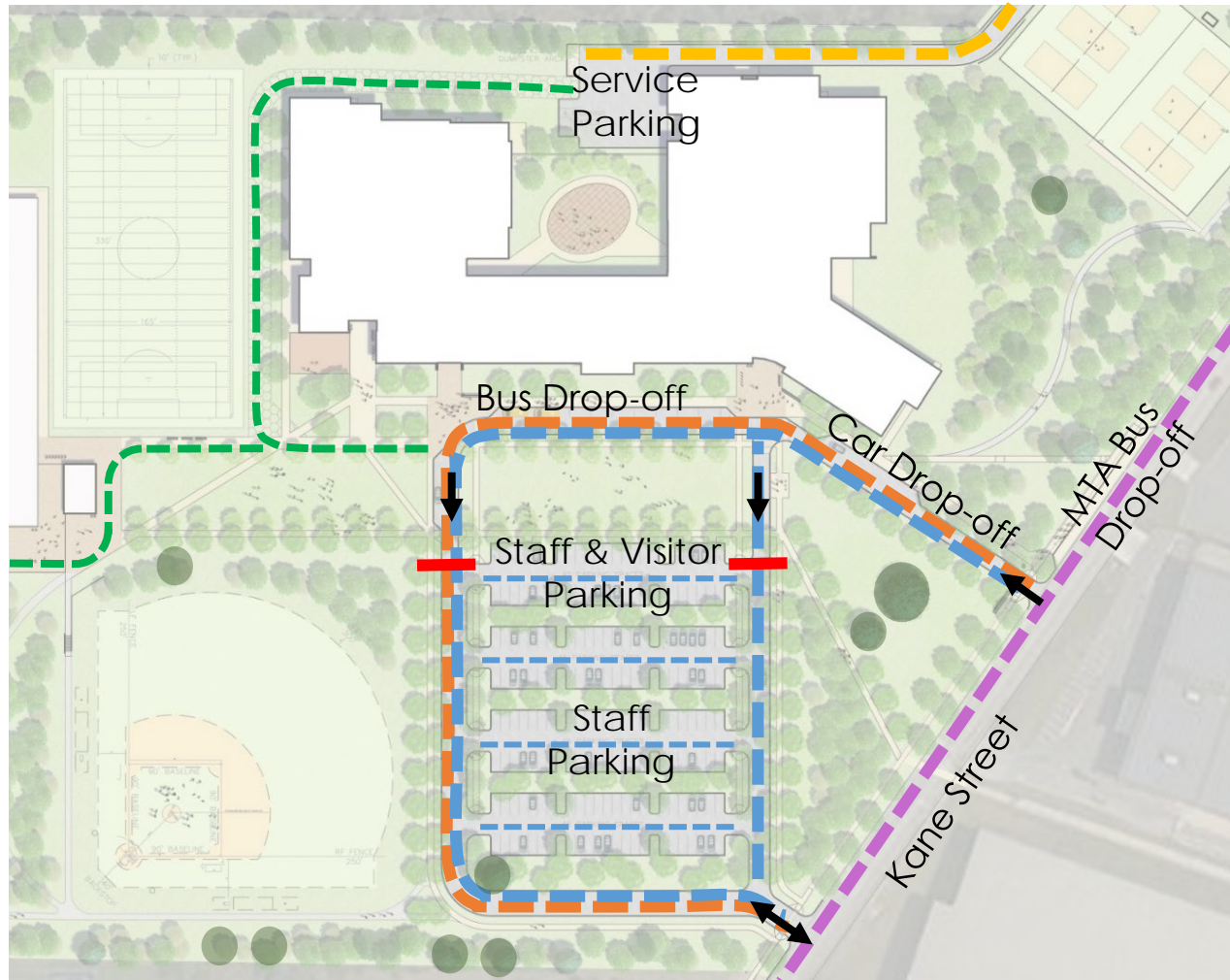

Improve On-Site Vehicular Circulation

- Clarify parking zones, student drop-off zones, and separate points of entry
- Minimize vehicular/pedestrian conflict

- School Buses
- Visitors & Staff Cars
- Service Vehicles
- MTA Buses
- Emergency Vehicles
- 2-Way Traffic Termination

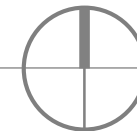

Site Construction Phasing

Phase 1



● Specimen Tree

Intermediate Condition – June 2019

- Build new school
- Complete courtyard landscape while continuing site work in other areas.

Phase 2



● Specimen Tree

Project Complete - December 2019

- Old school demolished,
- Balance of site work complete.

Site Sections

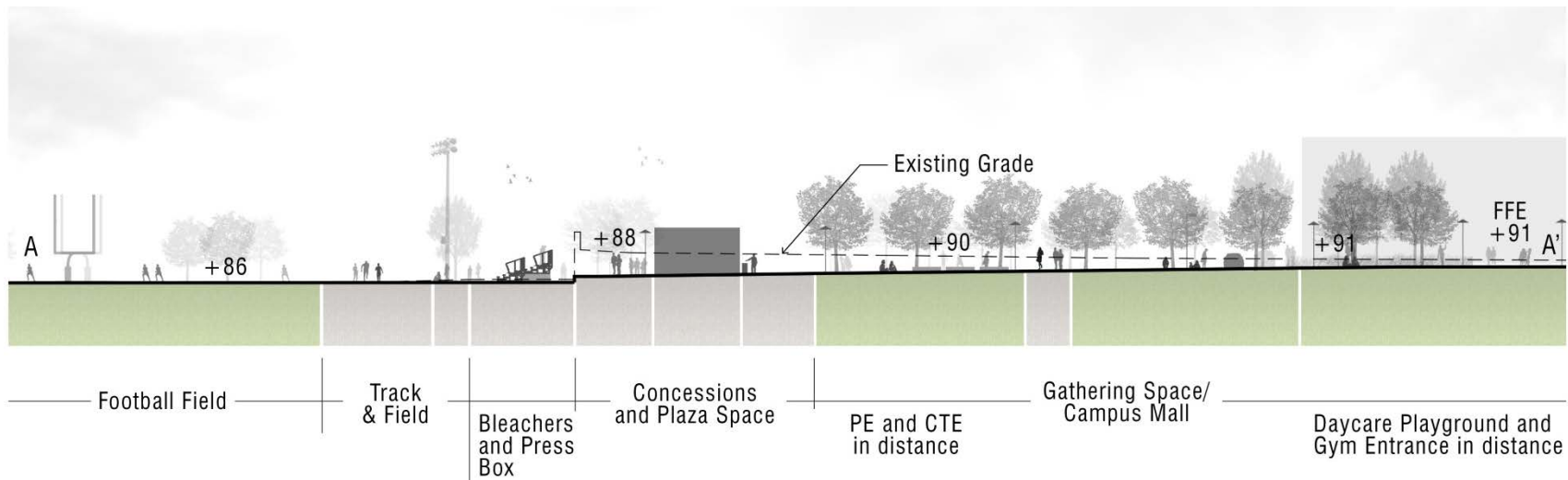
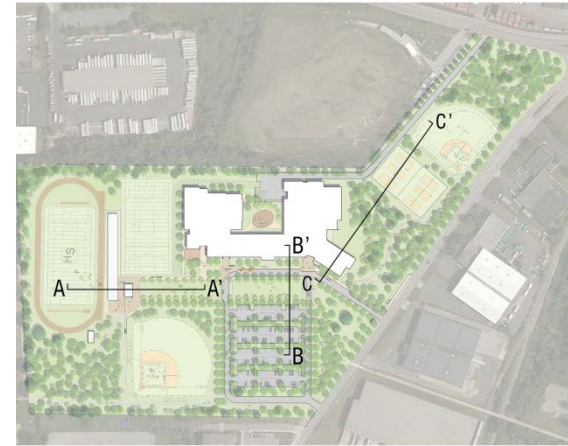
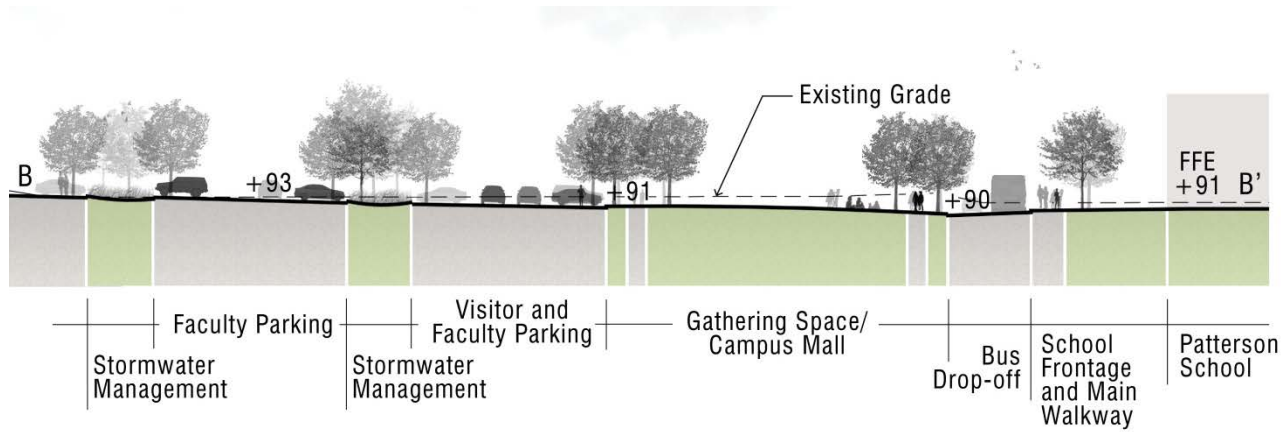

Site Sections

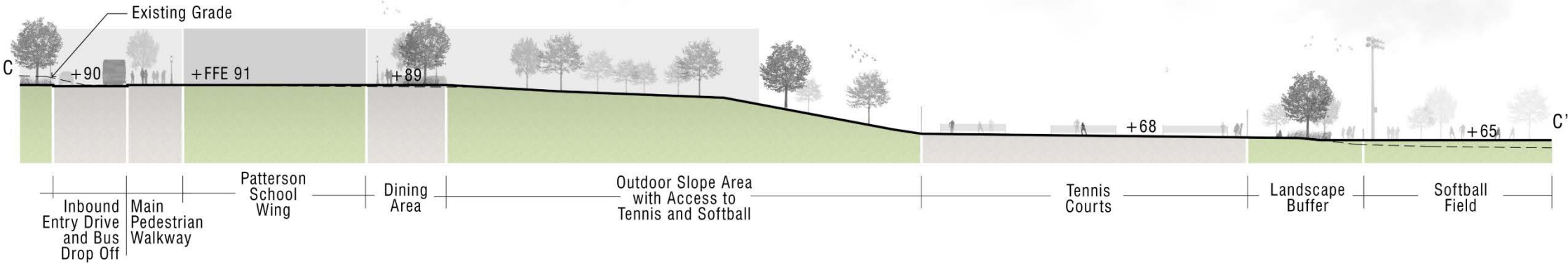
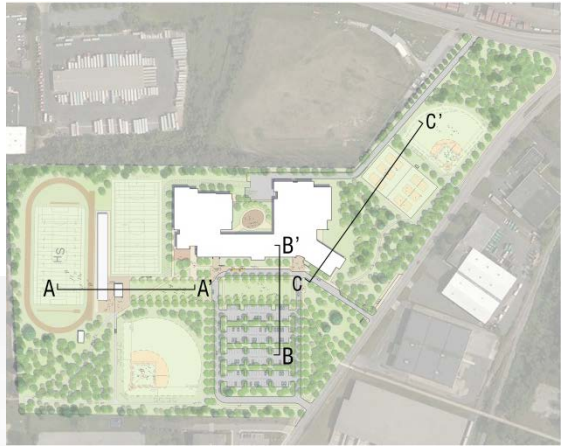

Precedent Imagery



1



2



3



3



1

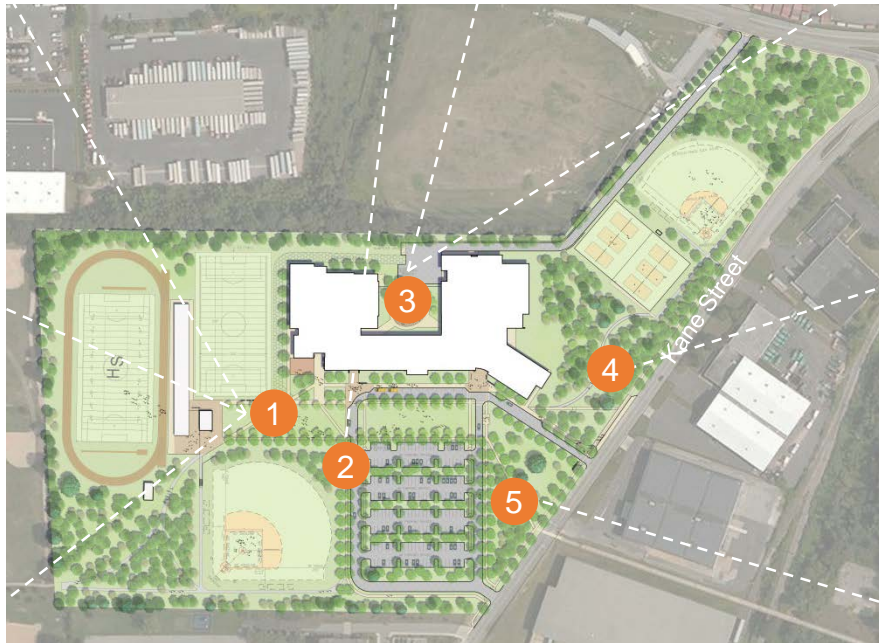

1

2

3

4

5



1



4



5

- 1 Plaza space adjoining ticketing and concessions building
- 2 Tree alley along major pedestrian walkways
- 3 Claremont outdoor recreation area
- 4 Dense tree plantings with educational opportunities
- 5 LED site lighting

Precedent Imagery



2



3



3



3



1



4



1



4

- 1 Sloped hillside and amphitheater effect with trees and rain garden
- 2 Planting Character
- 3 Primary school entrances with gathering spaces and raised crosswalks
- 4 Stormwater management and pedestrian circulation through parking area

Schematic Massing

Aerial



Schematic Massing

View from South on Kane



Schematic Massing

View from North on Kane



Schematic Massing

Patterson Entry



Schematic Massing

Claremont Entry



Baltimore City Public Schools
21st Century School Buildings Program
Maryland Stadium Authority



**PATTERSON HIGH SCHOOL
&
CLAREMONT MIDDLE/HIGH SCHOOL**
Grades 6 through 12

UDARP Work Session
06 April 2017

